

CRAIGHEAD COUNTY
Annual Taxpayer Transparency Improvement District Report*

Name of recorded district Big Creek Drainage District #15

FILED

AUG 12 2022

LESLI PENNY

COUNTY & PROBATE COURT CLERK

1. Formation Date Prior to July, 1938
2. Formation Statute: Ark. ACA Section 14-121-101 et seq.
3. Description of district's boundaries (Attachment: map of district)

See Map attached

4. District's commissioners, directors, or officers (name, phone number, address, email, term of Office)

- a. Terry Moody, 42 CR 201 Jonesboro, AR 72404 - (870) 974-3166 - moodyeq@sbcglobal.net - perpetual term until they resign
- b. Lindy Alexander, 920 Park Avenue, Jonesboro, AR 72401 - (870) 897-2330 - lindyalexander8@gmail.com - perpetual term until they resign
- c. Mickey Seeman, 2900 Browns Lane, Jonesboro, AR 72401 - (870) 243-6425 - mickeyseeman@yahoo.com - perpetual term until they resign
- d. _____
- e. _____
- f. _____
- g. _____
- h. _____

5. Vacancies on the district board or commission

None

6. Annual Meeting

Meetings are not scheduled, but called on an as needed basis.

Date	Time	Location
------	------	----------

7. General description of district's current and future maintenance and repairs

There are currently no long-term future maintenance and repairs planned. These are handled on an as needed basis.

8. Contracts (identity of parties to contracts and district's obligations)

a. None at this time.

b.

c.

d.

9. Current Indebtedness or Bond Indebtedness (with reason for indebtedness and payout or maturity date)

a. None at this time.

b.

c.

d.

10. Total existing delinquent assessments 19

Responsible Delinquent Collector Craighead County Tax Assessor

11. District Assessor (name, phone number, address, email)

The assessment of benefits was completed and approved at the time the district was formed. No one now serves as District Assessor.

12. Payee for distribution from County Treasurer (name, phone number, email)

Collected and forwarded to the District by the County Tax Collector or Treasurer, received by the District Secretary/Treasurer, Mickey Seeman

13. Explanation of statutory penalties, interest, and cost

These are set by state law, A.C.A. Section 14-121-426. Delinquent penalties are assessed by county officials.

14. Method used to calculate assessments (flat fee; per acre; per structure; etc.)

Upon information and belief, flat per acre tax is the basis of the assessment. Per state law, this does not require an assessment. This assessment computation was handled by the Craighead County Tax Collector in the past, but currently is being handled by the Craighead County Tax Assessor.

15. Statement itemizing the income and expenditures of the district for the most recent fiscal year (Attachment: balance sheet/bank statement)

Previously filed on April 7, 2022.

Completed By:

Mickey Segman

Print Name

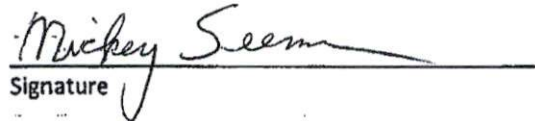
Signature

870-336-0725

Phone Number

8-11-2022

Date

*Required by Arkansas Code Act 359 of 2021

Form provided by: Wes Eddington
Craighead County Collector

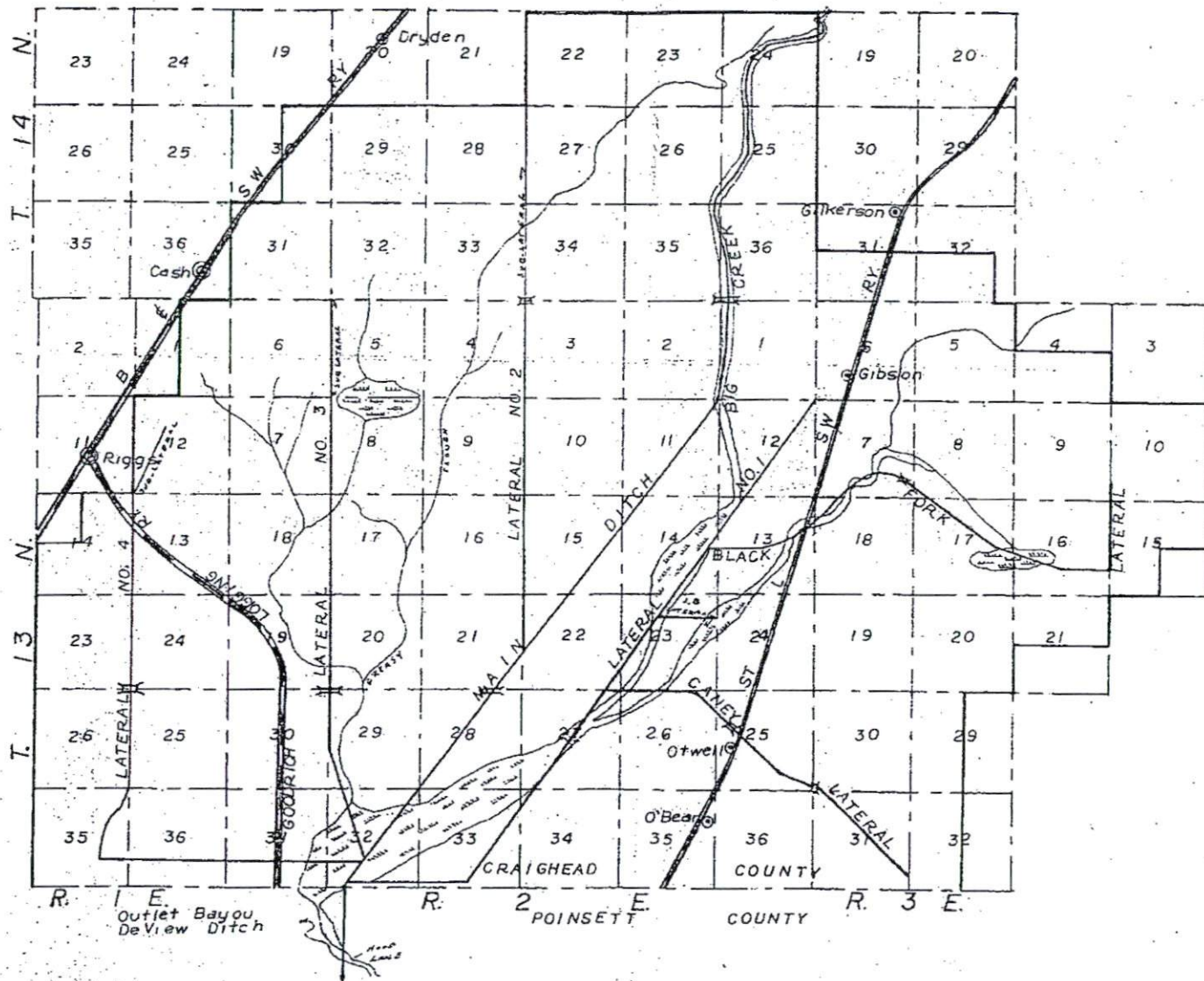

DRAINAGE DISTRICT NO. 15
CRAIGHEAD COUNTY ARKANSAS

FILED

APR 07 2022

LESLI PENNY

COUNTY & PROBATE COURT CLERK

IN THE COUNTY COURT OF CRAIGHEAD COUNTY, ARKANSAS
IN THE MATTER OF
DRAINAGE DISTRICT NO. 15

ANNUAL STATEMENT FOR 2021

Come the Commissioners of Big Creek Drainage District #15, Mickey Seeman,

Terry Moody, and Lindy Alexander, and present this as their accounting for the year

2021: BALANCE of funds on January 1, 2021: \$ 29,109.40

DEPOSITS:

2018 Taxes Collected	15,861.51	
Centennial Bank (interest on CDs)	45.00	
Centennial Bank (% on checking)	<u>23.18</u>	
Total Deposits		<u>+15,929.69</u>
		\$45,039.09

DISBURSEMENTS:

Legal Expenses	<u>480.00</u>	
Total Disbursements		\$44,559.09

BALANCE of funds on December 31, 2021: \$44,559.09

The district funds are currently held in the following financial institutions:

Centennial Bank checking account #2100444	\$29,559.09
Centennial Bank Certificate of Deposit #100073	\$10,000.00
Centennial Bank Certificate of Deposit #103033	\$ 5,000.00

Total funds of the district as of December 31, 2021, are \$44,559.09.

Respectfully submitted,

MICKY SEEMAN, TERRY MOODY,
and LINDY ALEXANDER, Commissioners

By 
Secretary-Treasurer

STATE OF ARKANSAS
COUNTY OF CRAIGHEAD

Mickey Seeman, Commissioner of Drainage District No. 15, personally appeared before the undersigned Notary Public and on oath stated that the foregoing is a true and correct accounting of funds received and disbursements made by Drainage District No. 15 during the year 2021 to the best of his information and belief.

WITNESS my hand and seal as such Notary Public on this 6 day of April, 2022.

Debra K Kimberland
Notary Public

My Commission Expires

Feb 3, 2027

